

MB Motor Bells



6" Bells

	Color	Order Code
MB-G6-12-R	Red	3942
MB-G6-12-S	Gray	4221
MB-G6-24-R	Red	3941
MB-G6-24-S	Gray	4222

10" Bells

MB-G10-12-R	Red	3944
MB-G10-12-S	Gray	4223
MB-G10-24-R	Red	3943
MB-G10-24-S	Gray	4224

UL Max. Current	24 VDC	12 VDC	dBA @ 10 ft.
	0.040	0.090	92

Mounting Options: D,E,J,K,N,O,P,R,S

MB motor bells provide a sound engineering bell for fire life safety alarm systems.

The 43T vibrating bells provide durable operation and dependable performance for indoor and outdoor installations.

Available features and options:

Color: Red or Gray

Mounting: Wall

Indoor or outdoor

Available in 6" and 10" sizes

Strobe Synchronization with RSSP strobe plate

Approvals: UL, ULC, FM, CSFM, MEA, BFP

43T Vibrating Bells



6" Bells

	Color	Order Code
43T-G6-24-R	Red	1627
43T-G6-24-S	Gray	1626
43T-G6-115-R	Red	1631
43T-G6-115-S	Gray	1630

10" Bells

43T-G10-24-R	Red	1647
43T-G10-24-S	Gray	3800
43T-G10-115-R	Red	1651
43T-G10-115-S	Gray	3693

Input Current	24 VAC	115 VAC	dBA @ 10 ft.
	0.410	0.085	86

Mounting Options: D,E,J,K,N,O,P,R,S

Series MB and 43T

6"

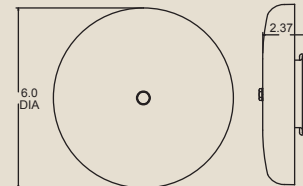

10"

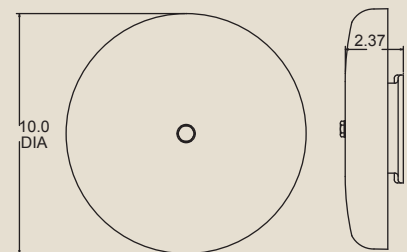

Please reference the back of this catalog for more information on mounting options.